PHOTOMETRIC PLAN

Illuminance calculations, uniformity review, and documentation prepared for permitting and design coordination.

DELIVERABLES

Calculated light levels • Uniformity • Summary tables

USE

Permit submittal • Design review • Procurement support

DOCUMENTATION

Print-ready ANSI B (17×11 in)



PHOTOMETRIC PLAN

Project Name: Baseball Field

Scope: Photometric Plan

Date: 05/14/25



Prepared by: Stetra Lighting

Checked by: Stefan T.

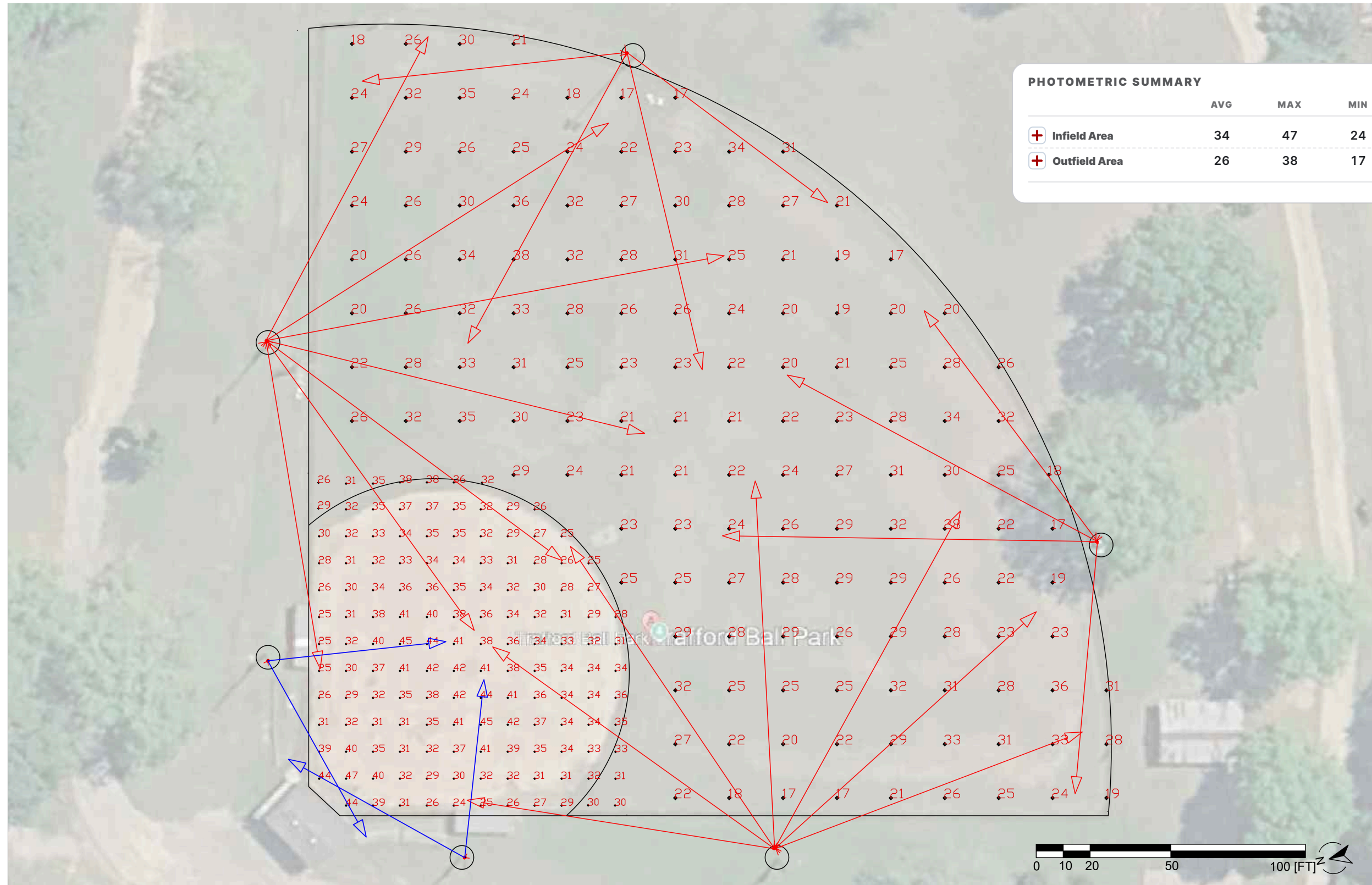

PHOTOMETRIC SUMMARY					FC
	AVG	MAX	MIN	AVG/MIN	MAX/MIN
⊕ Infield Area	34	47	24	1.42	1.96
⊕ Outfield Area	26	38	17	1.53	2.24

FIXTURE SCHEDULE

W / lm / ft / K

ID	SYMBOL	TYPE	QTY	P (W)	LM (LM)	MH (FT)	TILT (°)	KELVIN (K)	LLF
1	■	600-UNVL-40-30-BK	4	600	83704	60	0	4000	0.90
2	■	1000-UNVL-40-30-BK	22	1000	156000	60	0	4000	0.90

FIXTURE TOTALS

calculated

Fixture Types	2
Total Fixtures (Qty)	26
Total Connected Load (W)	24400
Total Lumens (lm)	3766816
Avg Efficacy (lm/W)	154.4
Lighting Power Density (W/ft²)	—

ASSUMPTIONS / NOTES

report

Photometric calculations are based on separate horizontal grids: 10 ft x 10 ft for the infield and 20 ft x 20 ft for the outfield, measured at 3 ft AFF. Light levels and uniformity are calculated separately for each area. Final field verification is recommended after installation.

1 600-UNVL-40-30-BK



2 1000-UNVL-40-30-BK



PHOTOMETRIC PLAN

Project Name: Baseball Field

Scope: Photometric Plan

Date: 05/14/25



Prepared by: Stetra Lighting

Checked by: Stefan T.

FALSE COLOR RENDER

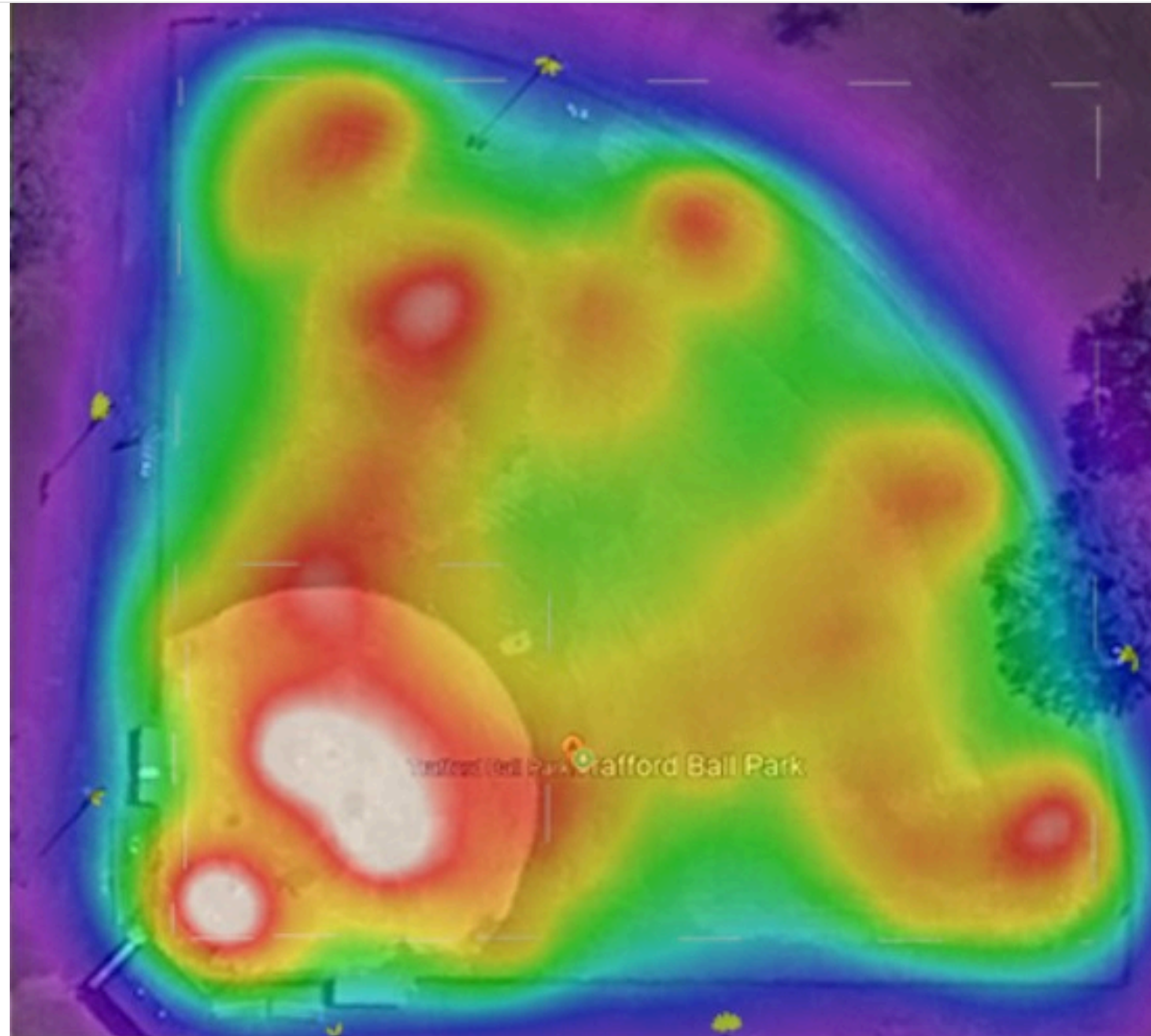

0 5.00 10.00 15.00 20.00 25.00 30.00 35.00 40.00

fc